



A Datamars Brand

PLEASE READ BEFORE USE

Z Tags One Piece Tags have changed!

Better.

Faster.

More Convenient.

Here at Z Tags, continuous product innovation is at the core of everything we do; and our one piece Z1 Tag is no different.

The tag still retains the same great quality and speciality retention features however, application with a loader is no longer needed. Follow our 4 step guide overleaf for application of the tag.

We have also created an instructional video; check it out at www.zeetags.com.au

Current as at 24/06/19

DATAMARS

**NEW
PROCESS**

**Z
Tags**TM
A Datamars Brand

Four Easy Steps:

NOTE: One Piece loader no longer needed with your order



Flick the tagger pin out horizontally and hold your thumb down on the top arm of the tagger. This locks the tagger pin into position.



Gently slide the tag onto the tagger pin until you feel the tagger pin touch the end of the tag. Straighten the tag's surgical tip.

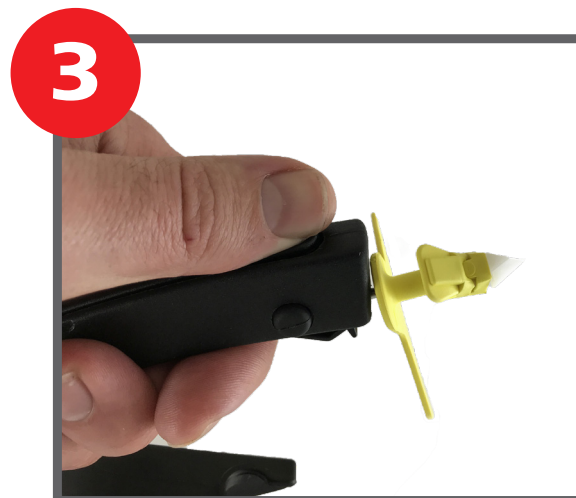

Push the rest of the tag onto the tagger pin.



Flick the tagger pin down vertically. Move the tag to the left or the right of the tagger, depending on which side the animal is being tagged, to ensure the tag is out of the way of the animal's head.

**Need further information?
Call 1800 641 324 or your local Territory Manager
www.zeetags.com.au**

DATAMARS